

## Overview

ARCHER RGB 50000 /60000 is an upgraded model from the ARHCER RGB 40000. Although the power output increases, the beam divergence remains relatively the same. The ARCHER RGB 50000/60000 laser offers a cost-effective yet stable and reliable quality, providing high-quality performance. It is suitable for customers with a limited budget who are not specifically seeking a thinner beam size.



Front Panel



Rear Panel



Front 45°



Rear 45°

## Specifications

### Light source

	<u>ARCHER RGB 50000</u>	<u>ARCHER RGB 60000</u>
Red :	11500 mw@638nm	11500 mw@638nm
Green :	16500 mW@529nm	19500 mW@529nm
Blue :	23000 mW@450nm	29000 mW@450nm

### Beam Profile

	<u>ARCHER RGB 50000</u>	<u>ARCHER RGB 60000</u>
Beam Diameter (Projector Window) :	10mm * 7.5mm	10mm * 7.5mm
Divergence (Full angle) :	~ 1.3mrad	~ 1.3mrad
Modulation :	Analog 50KHZ	Analog 50KHZ
Laser Class :	Class IV	Class IV

### Scanner

Galvo :	25kpps @ 8° ILDA test pattern
Scan Angle :	50° Max

### Interfaces & Controls

Control :	ILDA in (Differential), ILDA out
Safety :	Key Switch, FDA Scan-safe Switch
Remote Interlock :	5 pins XLR
Scan Image Invert :	Invert-X, Invert-Y, Rotate 90°
Mains :	Neutrik PowerCon® TRUE1 TOP

### Optional Components

Embedded Controller :	Pangolin FB4 (upon request)
Scanner :	EMS 9000 30Kpps digital scanner (48°Max angle)

# Product Information

## ARCHER RGB 50000/60000

**ABLE**  
LASER TECHNOLOGY

### Thermal Control

Cooling : Active Cooling/heating by TEC Peltier Elements  
Ventilation : 40mm Low noise thermal-controlled fan \* 8

### Electric

Operating Voltage : AC 110V-240V  
Power Consumption : 1200W Max

### Physical

L \* W \* H : 442mm\* 374mm\* 182mm (Without Yoke)  
Weight : 28kg (Without Yoke)  
Housing Materials : Black Anodized Aluminum  
IP grade : IP52  
Packaging : Flight case

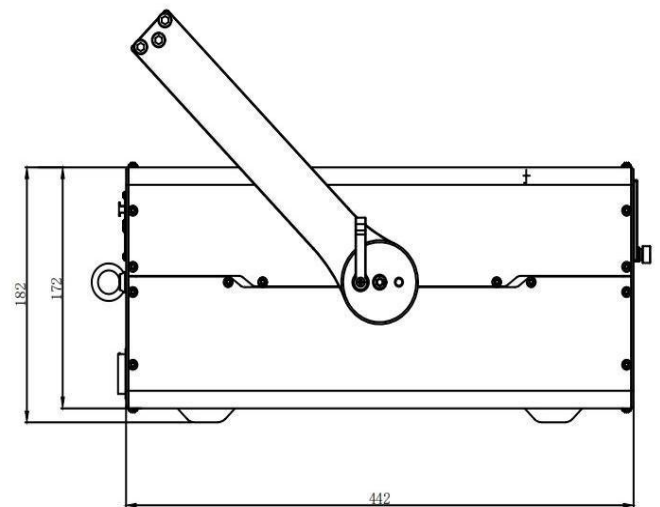
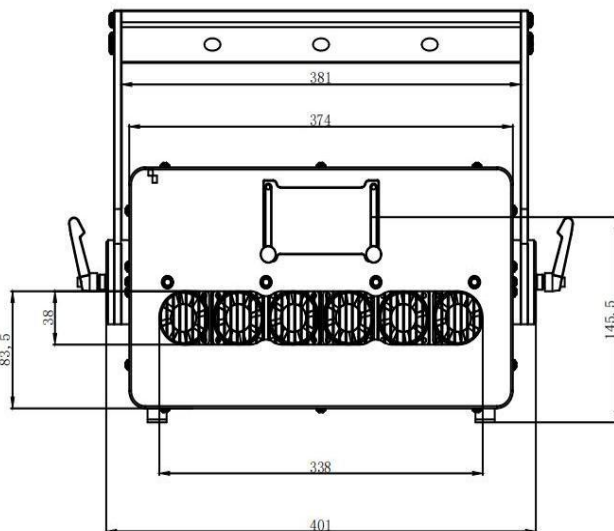

### Compliance

Compliance FDA/CDRH, CE

### Warranty

Warranty 24 months parts and labor

### ABLE LASER TECHNOLOGY

3 Floor, Tower C, Huaming Industrial Park, Huanjiao Village, Shijing Town, Baiyun District, Guangzhou, China  
TEL: +86 02 3639 7412 FAX: +86 02 3639 7413

[www.able-laser.com](http://www.able-laser.com)  
[sales@able-laser.com](mailto:sales@able-laser.com)